



BEYOND BOUNDARIES

2024 CUMU Conference | October 20–23 | Minneapolis–St. Paul, MN



BOARD OF DIRECTORS

CHAIR

Kristin Sobolik

Chancellor, University of Missouri-St. Louis

VICE CHAIR & TREASURER

Ellen Neufeldt

President, California State University San Marcos

MEMBERS-AT-LARGE

Steven Angle

Chancellor, University of Tennessee at Chattanooga

Virginia Arthur

President, Metropolitan State University

Loren Blanchard

President, University of Houston-Downtown

Franklin D. Gilliam Jr.

Chancellor, University of North Carolina at Greensboro

Sandra Haynes

Chancellor, Washington State University, Tri-Cities

Kenneth Jessell

President, Florida International University

Joanne Li

Chancellor, University of Nebraska at Omaha

Thomas Parham

President, California State University Dominguez Hills

Deidre Peaslee

President, Saint Paul College

Paul Pribbenow

President, Augsburg University

Antonio Tillis

Chancellor, Rutgers University-Camden

CEO OF ADMINISTRATIVE HEADQUARTERS

Mark R. Ginsberg

President, Towson University

EX-OFFICIO

Valerie Holton

Executive Director

Patrick Green

Editor, *Metropolitan Universities* journal

ABOUT CUMU

CUMU is the leading voice and forum for higher education leaders committed to urban and metropolitan communities. Our members are at the heart of what is happening in higher education and society, and are united by a shared commitment to leveraging higher education's power to address critical local, regional, and global issues.

Our strength lies in our network. We are a coalition of domestic and international, public and private academic institutions—liberal arts colleges, high research institutions, Minority Serving Institutions, community colleges, and religiously affiliated schools. We learn more from each other because of our geographic and institutional diversity.

Our year-round programming and annual conference provide opportunities for higher education leaders to explore the complexities of this work, share empirical research, and disseminate practices for enabling sustainable change driven by students, faculty, staff, and partners across the community. We welcome participation from across all functional areas, levels of responsibility, disciplines, and forms of community partnership.

We invite you and your entire campus to be an active part of our growing coalition.

DOWNLOAD THE CUMU 2024 APP

Thank you to our Conference App sponsor Academic Search

GETTING STARTED

1. Scan the QR code or download the Whova app from your app store.
2. Sign-in with the email address used for your conference registration.
3. Edit your profile to network with attendees.

SCAN TO DOWNLOAD THE APP



CONFERENCE VENUE MAP

FLOOR 4

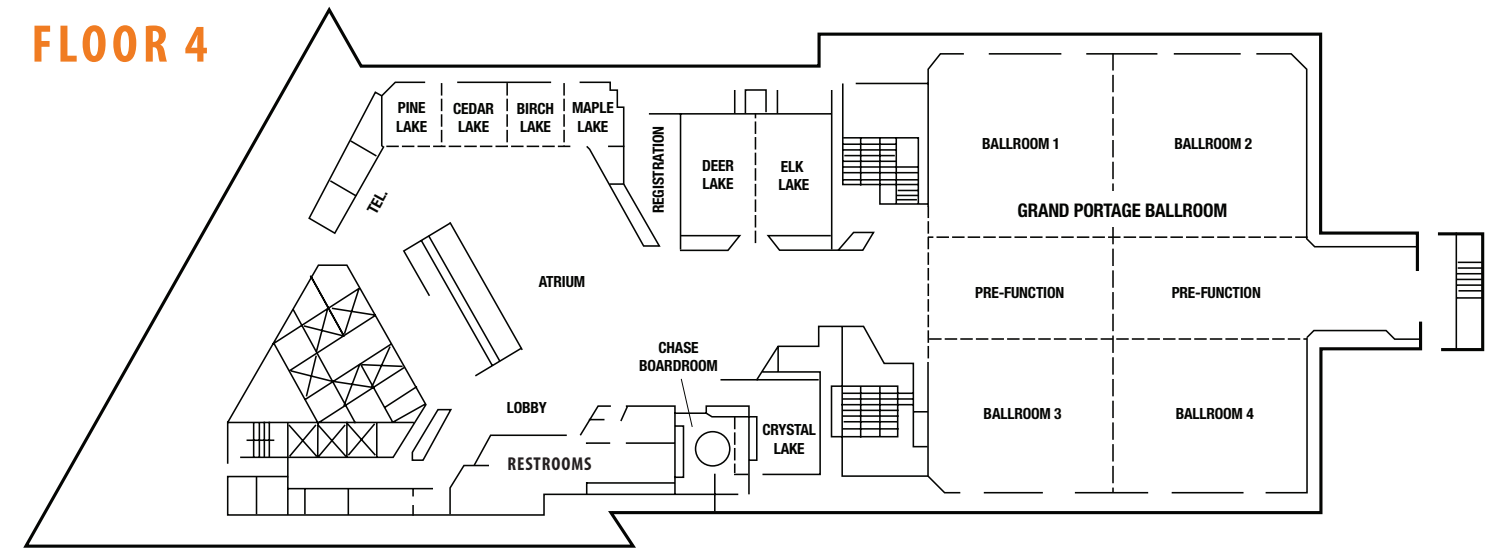

FLOOR 6

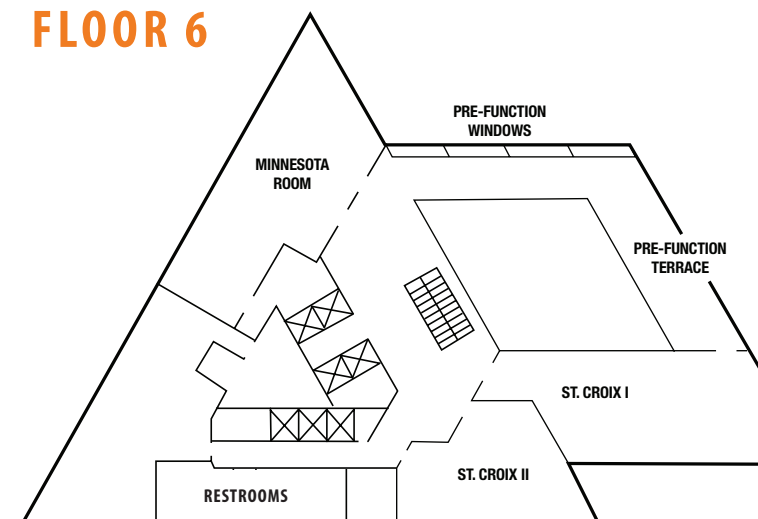

SUNDAY, OCTOBER 20

Ballroom 1	
3:00PM	Pre-conference Meetings of the Anchor Learning Network and Huddles
5:15PM	
8:00PM	Welcome Meet and Greet (Hotel Lobby Bar)
9:00PM	Thank you to our Welcome Meet and Greet sponsor The University of Tennessee at Chattanooga

As of 10/01/2024

Thank you to our local campus partners





MONDAY, OCTOBER 21

	Ballroom 3	Ballroom 4	Birch/Maple	Crystal Lake	Deer Lake	Elk Lake	Pine/Cedar
8:30AM			From Campus to Community: Implementing Trauma-Informed Care in Higher Education <i>(Registration Required)</i>		From Campus to Career - Educating Citizen Professionals for Community Impact <i>(Registration Required)</i>	Leading Systemic Change Using the Change Leadership Toolkit (CLT) <i>(Registration Required)</i>	Expanding your Basic Needs Ecosystem <i>(Registration Required)</i>
11:30AM	Plenary and Lunch: The Art of Science (Ballroom 1)						
1:15PM	Thank you to our Monday Lunch sponsor Florida International University						
1:30PM	The Power of Connections: A University Based Youth Center on an Urban Campus	The Leeds Beckett University Purchasing Engagement Plan (PEP)	Equity by Design	Shaping Career Pathways through Experiential Learning and Leadership Development	The Freedom to Learn: Confronting Censorship in Higher Education	Forum on School Partnerships	Voices of Transformation: Exploring Health Inequity through Courageous Conversations with First Generation Students
2:15PM							
2:30PM	Exploring the Impact of Community Service Courses on Undergraduate Well-Being: A Five-year Study	Paterson One Square Mile: Addressing Early College and College Readiness through a Place-Based Collective Impact Model	Connecting across Railway Lines: Reflections on Urban and Economic Development in Cape Town, South Africa	Regional Economic Innovation: Model of Community Engagement	Forum on Health Partnerships	Implementing Data-Driven Strategies to Reduce Equity Gaps in DWIF Rates	The "Live-Work-Learn" Program - Leveraging Relationships between Students, Businesses, and your Institution
3:15PM							
3:30PM	International Perspectives on Civic Universities and their Socio-Economic Impacts	The Success of Hispanic Serving Institutions in Achieving Social and Economic Mobility	Increasing the Presence of Black Male Instruction in K-12 through Partnerships and Pipeline Development	Transforming Pittsburgh's Postindustrial Waterfront for Innovation and Equitable Growth	Forum on Internal Grants	Learning from 20 Years of Partnership between the University of Minnesota and Hennepin County	Downtown Scholars Initiative: Creating Innovative Pathways for Underrepresented Student Populations
4:15PM	Poster Session and Reception (Floor 6. See page 8 for poster titles.)						
5:30PM	Presidents' Dinner (5:30PM meet at first floor hotel entrance near elevators for transportation, <i>Invitation Only</i>)			Presidents' Dinner (5:30PM meet at first floor hotel entrance near elevators for transportation, <i>Invitation Only</i>)			
9:00PM	<i>As of 10/01/2024</i>						

■ Anchor strategies
■ Belonging, equity, and justice
■ Democracy
■ Impact
■ K-16 partnerships
■ Social and economic mobility
■ Other

Refer to the conference app for complete presentation details and presenter information.

TUESDAY, OCTOBER 22

	Ballroom 3	Ballroom 4	Birch/Maple	Crystal Lake	Deer Lake	Elk Lake	Pine/Cedar
7:00AM	Breakfast (Ballroom 1)			Thank you to our Tuesday Breakfast sponsor California State University San Marcos			
8:00AM	Community Experiences <ul style="list-style-type: none"> ▶ Getting Down with Augsburg in Cedar-Riverside: Exploring Campus/Community Connections, Augsburg University ▶ Re/Envisioning Land Back: University-Native American Community Collaborations in the Twin Cities, Metropolitan State University ▶ Anchoring a Community College: Past, Present, and Future, Saint Paul College ▶ Mapping Prejudice and Resilience: Remembering the Silenced Voices of Resistance, University of Minnesota 			Community Experiences (Meet in Ballroom 1 at 7:45AM. Buses depart at 8:00AM. Registration required.)			
11:30AM	Plenary and Lunch: Break the Wheel: On Social Justice and Police Reform (Ballroom 1)			Thank you to our Tuesday Lunch sponsor Rutgers University-Camden and Holland Award sponsor University of Louisville			
1:15PM							
1:30PM	Universities as Agents of Democracy: Moving Beyond Student Voter Registration	Behind the Scenes: Operations, Strategies, and Values Sustaining Four Universities' Anchor Partnerships	Activating Place-based Partnerships for Equitable Economic Development: A Playbook for Anchor Collaboratives	Inclusive Innovation: Engaging the Great Minds in All Communities	An emerging Anchor Strategy to Reduce Silicon Valley's Racial Wealth Divide	Forum on Paid Student Internships	The Process is The Prize: Reflections on Leveraging the Carnegie Community Engagement Application
2:15PM	Beverage and Snack Break (4 th Floor Atrium)			Beverage and Snack Break (4 th Floor Atrium)			
2:45PM	Dreaming and Scheming Together: Uniting Community Engagement and Diversity Leaders	Building the Tolleston Opportunity Campus: An Impact Engine	Practitioner-Scholar Inquiry in <i>Metropolitan Universities Journal</i> : Developing Lines of Inquiry to Foster Scholarship on Campuses and Communities	Augsburg Local: A Framework for Advancing Anchor Institution Strategies Amidst Changes in Campus and Culture	Carnegie Mellon University + Burrell High School Digital Writing Center: A Dynamic and Mutually Beneficial Student Support	Forum on Supporting Vulnerable Students	Co-Creating Inclusive Campus Communities through Collaborative Tech
3:30PM	Reception at Augsburg University (Meet in 4 th Floor Atrium near elevators. Transportation provided.)			Thank you to our Signature Reception sponsor Augsburg University			
6:00PM	As of 10/01/2024						

WEDNESDAY, OCTOBER 23

	Ballroom 3	Birch/Maple	Deer Lake	Elk Lake	Pine/Cedar
7:00AM	Breakfast (Ballroom 1)		Breakfast (Ballroom 1)		
8:00AM	Connecting scholarship with a public audience: a Discussion with the Towson University Public Scholarship Faculty Fellows	Leading the Institutionalization of Community Engagement in Higher Education: An Administrator's Perspective	Assessing Community Impact: Developing an Assessment Instrument	Sustaining Anchor Impact: University of Missouri-St. Louis and the St. Louis Anchor Action Network's Five-Year Journey	Rutgers University Camden - Community Partnership Centers (RUG-CPC)
8:45AM					
9:00AM	Reverse the Trend: Create a Prison to College Pipeline	Faculty Fellows Ambassadors: Enhancing Community Engagement On & Off Campus	Leveling Up: Infusing Asset Based Community Development (ABCD) in Community-Engaged Research and Sharing its Impact	A New Strategy for Measuring and Communicating the Anchor Institution Impact: Penn & Philly	A Prologue to Quantifying the Complexity and Impacts of Community Engaged Research
9:45AM					
10:00AM	Roundtables (Ballroom 1. See page 9 for roundtable titles.)		Roundtables (Ballroom 1. See page 9 for roundtable titles.)		
11:15AM	Closing Session (Ballroom 1)		Closing Session (Ballroom 1)		
11:45AM	As of 10/01/2024				

- Other
- Social and economic mobility
- K-16 partnerships
- Impact
- Democracy
- Belonging, equity, and justice
- Anchor strategies

Refer to the conference app for complete presentation details and presenter information.

POSTER SESSION AND RECEPTION

Floor 6

Monday, October 21, 4:15–5:30PM

Join us for drinks and hors d'oeuvres at this interactive poster session and reception!

Thank you to our Poster Session sponsor University of Nebraska Omaha

The posters will be on display on floor 6 beginning Monday, October 21 at 9:00am and ending Tuesday, October 22 at 10:00AM for any conference attendees who want to peruse them before or after the poster session.

Anchor Strategies

1. Academic-Civic Collaboration: The Baltimore Immigration Summit
2. The Hornet Community Bus Tour: 3 years of Cultivating Community Partnerships and Belonging
3. Anchoring a Historically Black Community through University-Community Partnership
4. Spanning Ideological Boundaries: Understanding Rival Views of Higher Education as a Public Good
5. Key Principles for University-Community Partnerships: A Qualitative Case Study of a Successful Coalition During the COVID-19 Pandemic

Belonging Equity and Justice

6. "Deconstructing White Feminism" Initiative: Strategies for Implementing and Evaluating Targeted Anti-racist Programming
7. A Community & University Partnership to Re-Open an Urban Public Library After Being Closed for 39 Years
8. Building an Engagement Ecosystem and Glossary: Beyond Boundaries and Silos
9. How Do We Know? A New Way to Measure the Impact of Urban Experiential Learning on Cultural Intelligence
10. Supporting Incarcerated Parents and Families: A Collaborative Approach Across Academic, Correctional and Community Borders

Democracy

11. Collaborative Online International Learning/Virtual Exchanges (COIL/VE): International Learning without Travel

Impact

12. [Un]learning: Assessing Student Growth and Skill Development During Transdisciplinary Community-Engaged Courses at the University of Akron
13. Building a Sustainable Urban Food Systems Initiative
14. Evaluated by Students, for Students: Participatory Evaluation of a Justice-Oriented Anchor Program
15. University of Maryland Baltimore's Community Engagement Story

K16 Partnerships

16. Addressing the Critical Talent Gap in Transportation: Unexplored Career Pathways and High School Students
17. HackGood4 Baltimore Hackathon Introduces Baltimore City Public School Students to STEM Fields and Eco Activism

ROUNDTABLES

Ballroom 1

Wednesday, October 23, 10:00–11:15AM

Join us for engaging roundtable presentations and networking opportunities!

Stay for the closing session and giveaway immediately after the roundtable session.

Attendees choose 3 roundtable discussions to attend. Each presenter is assigned to a table and participants join the table for a 25 minute conversation, then move on to the next table of their choice for a total of three 25-minute conversations.

1. **CUMU Roundtable:** Writing a Successful CUMU Conference Proposal

2. **CUMU Roundtable:** Ideating and Submitting an Article in *Metropolitan Universities Journal*

Anchor Strategies

3. Beyond Silos with the John A. Maisch Collective for the Greater Good: A Pathway to Sustainable Academic-Community Partnerships
4. Building Community-Engaged Learning Opportunities Through Interprofessional Mentorship
5. Developing a Vendor Fair to Increase Local and Inclusive Purchasing

Belonging Equity and Justice

6. A Community of Care: Mental Health First Aid and Saint Paul College
7. Beyond Wellness: Advancing Collective Organizational Wellbeing in Higher Education
8. Building Family Partnerships Toward Equitable Community Engagement and Integration in STEM Education
9. Healthcare, Education, and Campus Collaboration: What Can Community-led Systemic Justice Look Like?
10. How Belonging for BIPOC Graduate Students Was Achieved Via Community Engaged Scholarship
11. Navigating Legacies of Distrust on the Path to Equitable Communities: Collaborations with Historically Underserved and Exploited Communities

Democracy

12. What Does Finding Common Ground Look Like In A Hyperpolarized Democracy? Insights from the Unify Challenge College Bowl Ahead of the 2024 Presidential Elections

Impact

13. Aligning higher education community engagement with the Sustainable Development Goals

14. Bridging Community: Sociological Engagement & Student Outcomes

K16 Partnerships

15. Experiencing STEAM in the City
16. Mindfulness and Community-based Service Learning: An Innovative Pedagogical Strategy for HS-College Partnerships
17. Post-Doctoral Fellowships and Translational Education Research in Practice
18. Refining the Partnership Ecosystem from Education to Workforce through Culture Change

Social and Economic Mobility

19. Empowering Social Mobility Through Peer Support: Insights from the Building Blazers Behavioral Health Project
20. Incentivized Engagement: Using Internship Stipends to Support Underrepresented Students
21. Supporting Capacity Development in Underserved Communities Using Processes to Pursue External Funding

CONNECT. LEARN. COLLABORATE.

We help our members contend with the complexities of their work by providing opportunities for the exchange of ideas for how to break down barriers and institutionalize practices that enable intentional, transformative change involving students, faculty, staff, and community partners.

Not Currently a CUMU Member?

Learn more and join at www.CUMUonline.org/Membership

METROPOLITAN *Universities*

SESSIONS WITH METROPOLITAN UNIVERSITIES JOURNAL EDITOR PATRICK M. GREEN

- ▶ **Practitioner-Scholar Inquiry in Metropolitan Universities Journal: Developing Lines of Inquiry to Foster Scholarship on Campuses and Communities**
October 22, 2:45–3:30 PM – Birch/Maple
- ▶ **CUMU Roundtable: Ideating and Submitting an Article in Metropolitan Universities Journal**
October 23, 10–11:15 AM – Ballroom 1/2

Get involved. Become a peer reviewer.

MUJ is seeking scholars and subject matter experts to serve as peer reviewers. All MUJ submissions undergo a double-blind peer review process and reviewers are matched based on scholarship and interests. Email muj@cumuonline.org for details.

CALLS FOR PAPERS

Metropolitan Universities journal (MUJ) is a peer-reviewed, open-access journal for evidence-based scholarship, research, and theoretical perspectives relevant to urban and metropolitan campuses. The journal accepts manuscripts on an ongoing basis for themed and non-themed issues.

- ▶ **2024 CUMU Conference Issue: Beyond Boundaries**
Guest Editor: Laurie Van Egeren, University of Minnesota
Submission Deadline: December 1, 2024 | **Issue Publication:** Summer 2025

Barbara A. Holland Scholar-Administrator Award

This annual award honors a bold, mid-career scholar-administrator whose leadership and intellectual voice illuminates the transformative power of urban and metropolitan higher education.

2025 applications will open in April 2025.
CUMUonline.org/Holland-Scholar

AWARDEES

- 2024: Brenda M. Kowalewski, Weber State University
- 2023: Henry Cunningham, University of Louisville
- 2022: Patrick Green, Loyola University Chicago
- 2021: Lina Dostilio, University of Pittsburgh and Deirdre Gonsalves-Jackson, Virginia Wesleyan University
- 2020: Lynn E. Pelco, Virginia Commonwealth University
- 2019: Euan Hague, DePaul University
- 2018: Emily Janke, University of North Carolina at Greensboro

SAVE *the* DATE

CUMU²⁰²⁵
CONFERENCE
BALTIMORE · OCTOBER 26-29

UPCOMING OPPORTUNITIES TO GET INVOLVED WITH CUMU

Visit our website to learn more

Anchor Learning Network (ALN)

ALN is a cohort-based program offered at no cost to individuals from CUMU member institutions in order to advance the higher education anchor mission. During the nine-month program (February through October), participants learn together and build their own professional network in support of their institution's anchor mission.

Applications for the 2025 cohort are open. Apply by Friday, December 12.

Huddles

CUMU Huddles are informal, online learning communities for individuals from across the CUMU network to connect, learn, and collaborate around shared challenges and common goals.

2025 registration is open now for Huddles.

Virtual Programs

Throughout the year, individuals from CUMU member institutions can participate in our fully online programs including community conversations around key topics of interest, webinars presented by fellow CUMU members, as well as the MUJ Dialogue Series which brings journal editors and authors into conversation with each other and with the CUMU membership.

Check the Events and Deadlines listing on our home page for more information about all of our upcoming programs.

THANK YOU TO OUR SPONSORS

TITLE SPONSORS



CHAMPION SPONSORS



LOCAL CAMPUS PARTNERS



PARTNER SPONSORS

